

12/4/2025
R:\Projects\23-070.01 W-5805G\Traffic\TCP\Plan Sheets\Title and Legend\W-5805G_TMP-01.dgn
User:stuart.bourne

STATE OF NORTH CAROLINA
DIVISION OF HIGHWAYS

TRANSPORTATION MANAGEMENT PLAN

VANCE COUNTY

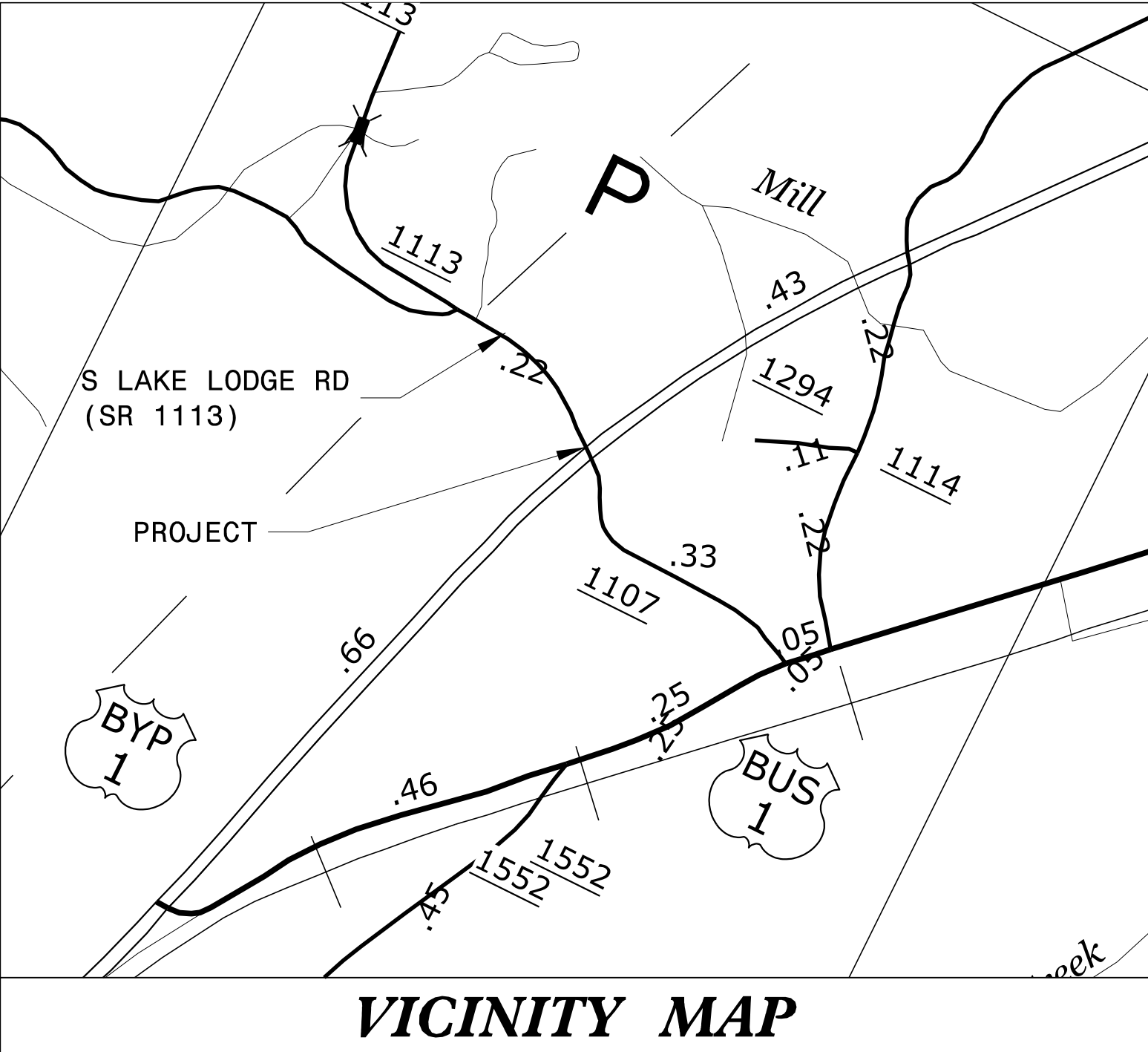
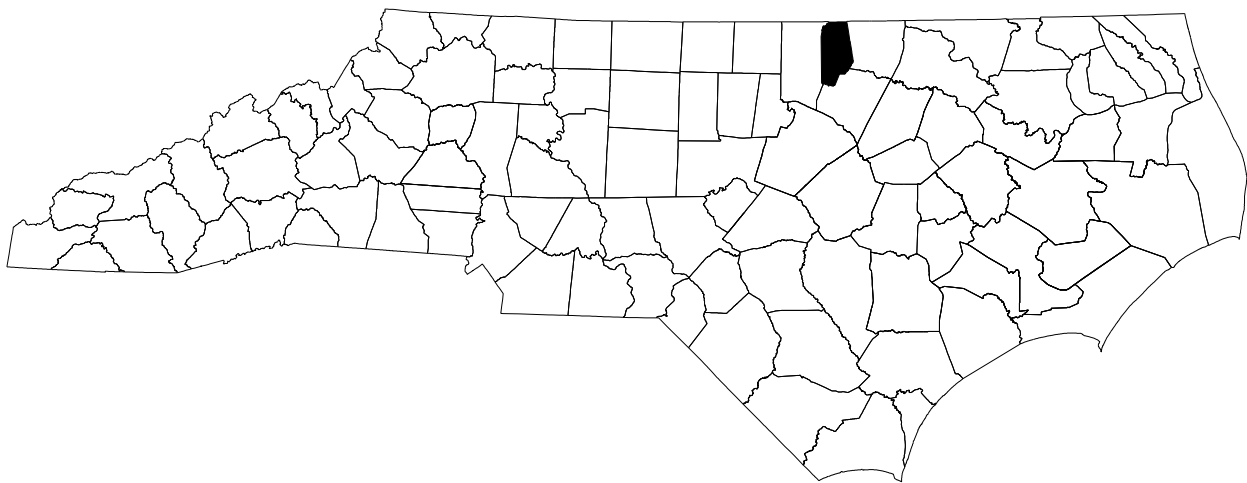

VICINITY MAP

NOTE: THIS PROJECT DOES NOT FALL WITHIN ANY MUNICIPAL BOUNDARIES.

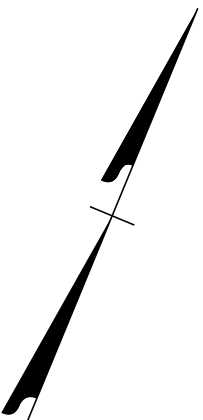

LOCATION: INTERSECTION OF US 1 AT SR 1113 (S LAKE LODGE RD)

TYPE OF WORK: GRADING, DRAINAGE & PAVING

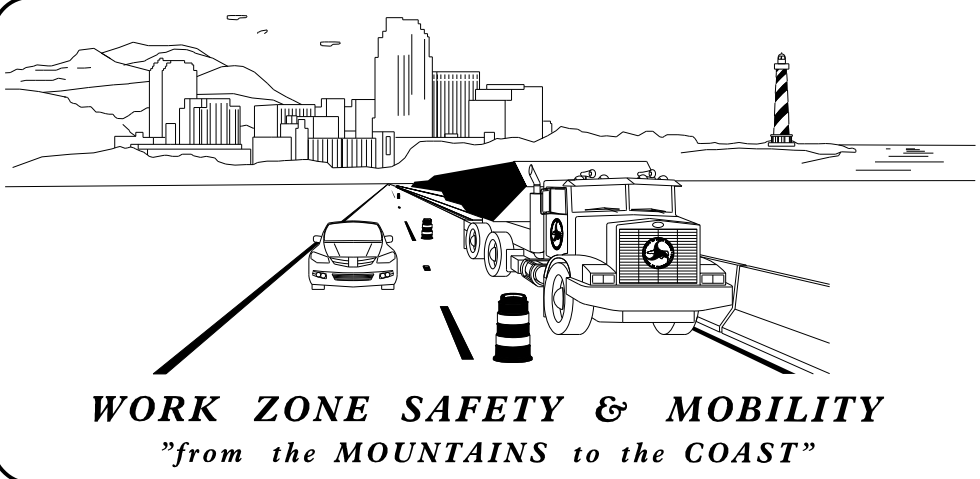

PLANS PREPARED BY:

J. S. BOURNE, PE

DIVYA PAPPU, PE

NCDOT CONTACTS:

MATTHEW NOLFO, PE
PROJECT MANAGER

MARK CRAIG, PE
DIVISION CONSTRUCTION ENGINEER

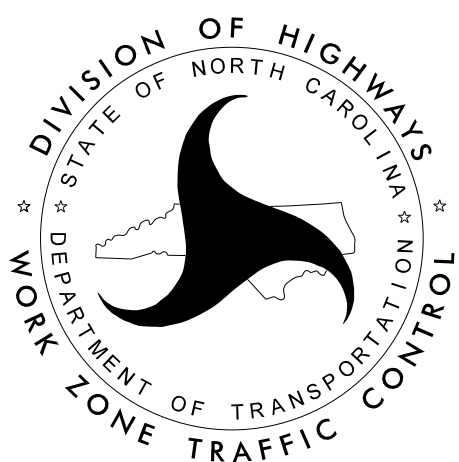

INDEX OF SHEETS

SHEET NO.

TITLE

TMP-01	TITLE SHEET, VICINITY MAP, INDEX OF SHEETS, AND TRAFFIC MANAGEMENT STRATEGIES
TMP-1B	GENERAL NOTES
TMP-02	ROADWAY STANDARD DRAWING AND LEGEND
TMP-03	TEMPORARY TRAFFIC CONTROL PHASING
TMP-04 TO TMP-06	TEMPORARY TRAFFIC CONTROL PHASE I DETAILS
TMP-07 TO TMP-09	TEMPORARY TRAFFIC CONTROL PHASE IIA DETAILS
TMP-10 TO TMP-12	TEMPORARY TRAFFIC CONTROL PHASE IIB DETAILS
TMP-13 TO TMP-15	TEMPORARY TRAFFIC CONTROL PHASE III DETAILS

TRAFFIC MANAGEMENT STRATEGIES

- TRAFFIC WILL BE MAINTAINED DURING CONSTRUCTION USING A SERIES OF DAILY LANE CLOSURES ON US 1
- FLAGGERS WILL BE USED ON SR 1113 TO CONSTRUCT WIDENING AND MONOLITHIC ISLANDS

DOCUMENT NOT CONSIDERED FINAL
UNLESS ALL SIGNATURES COMPLETED

ICE of CAROLINAS, PLLC
ICE of Carolinas, PLLC
4505 Falls of Neuse Road, Suite 110
Raleigh, North Carolina 27609
Phone: 803-822-0333
License #: P-0999

APPROVED: J. Stuart Bourne
DATE: 12/4/2025

SEAL

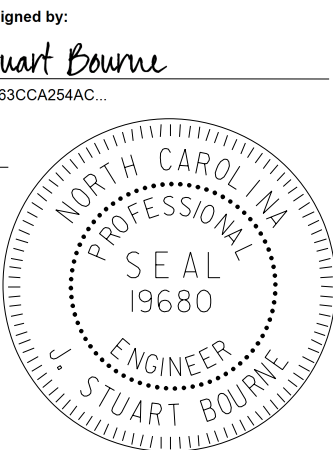

TIP PROJECT: W-5805G

SHEET NO.
TMP-01